

STANDARD GEOMETRY
FOR M3-06-HT01-10

NOTES:

1. Exterior material - SS 316L
2. Surface roughness Ra 1.6 μm or better
3. Weld line may protrude or be visible near mid-line of XBOT

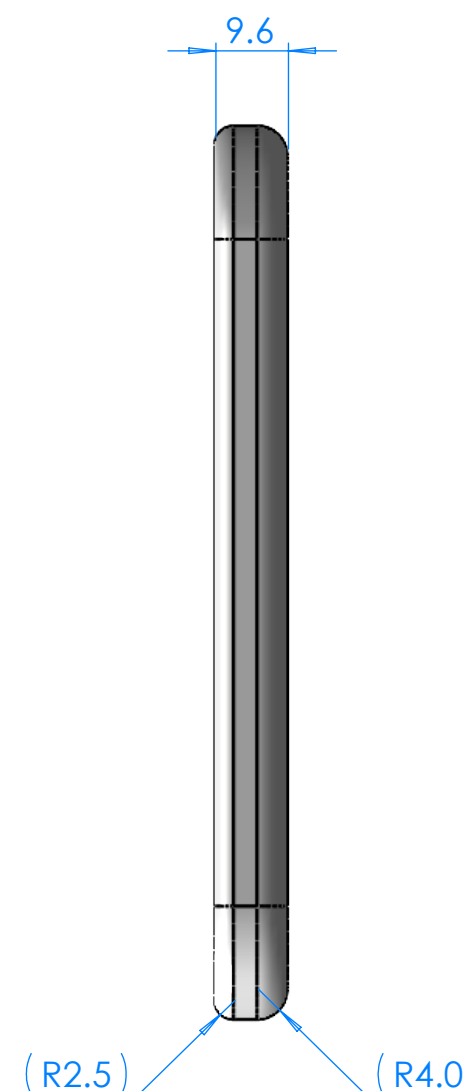
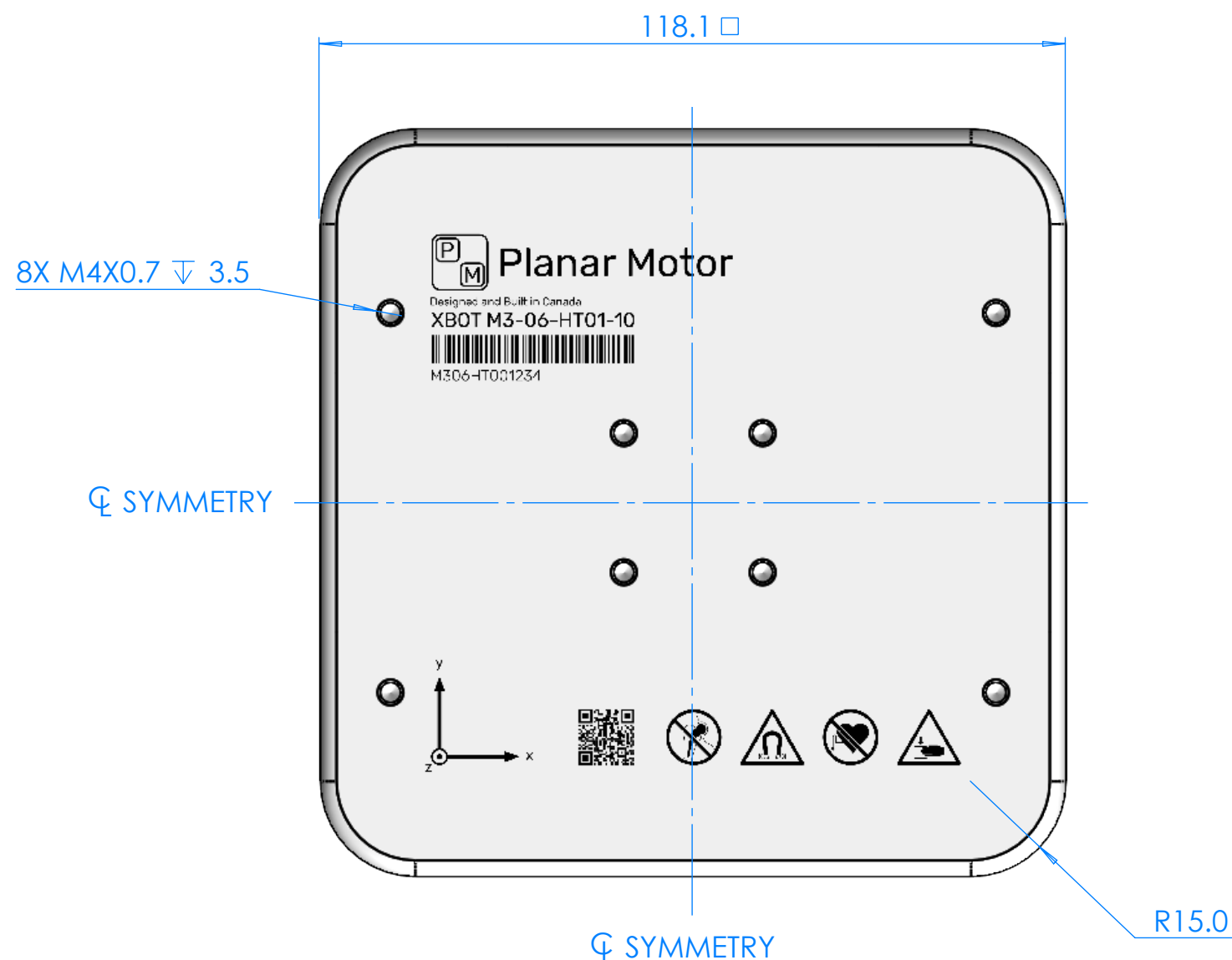

PRODUCT
DRAWING

Dimensions and tolerances per ASME Y14.5M-1994
Surface texture per ANSI/ASME B46 1-1985

Product dimensions subject to change

Model
**XBOT M3-06-HT01-10,
HIGH TEMPERATURE
HYGIENIC**

Dwg. No.

M3-06-HT01-10-OEM

Rev.

0

Planar Motor Incorporated - Vancouver, Canada

Issue Date
2025/09/16

Projection

Dimension
mm

Size
A3

Scale
1:1

Sheet
1/1